



CANADIAN WILDLIFE FEDERATION

Garden layout examples and printable templates

- In this pdf you will find a compilation of examples of garden layouts and printable templates to help you design your garden. These resources were provided by local native plant nurseries across Canada and compiled by CWF.
- Please note the example plant lists may not be native to your area of Canada.
- To create your own list of plants, check out our online resources: [Plant Chart](#), [Native plant encyclopedia](#)

Garden layout examples and printable templates



Wild About Flowers

Native Plant Nursery

Designs created by
Wild About Flowers
Native Plant Nursery
in Foothills County, AB

403-933-3903

office@wildaboutflowers.ca

www.wildaboutflowers.ca

Location: 402098 96 St West, Foothills, AB T1S 6A5

Sales yard is by appointment

Garden layout examples and printable templates



Wild About Flowers
Native Plant Nursery



Let's design a Pollinator Garden.

Can you put the wildflowers in the right place? The circle sizes indicates the mature width of the plants. Use the heights listed below as clues to where the plants belong in this garden.

Native Alberta Wildflower Pollinator Garden

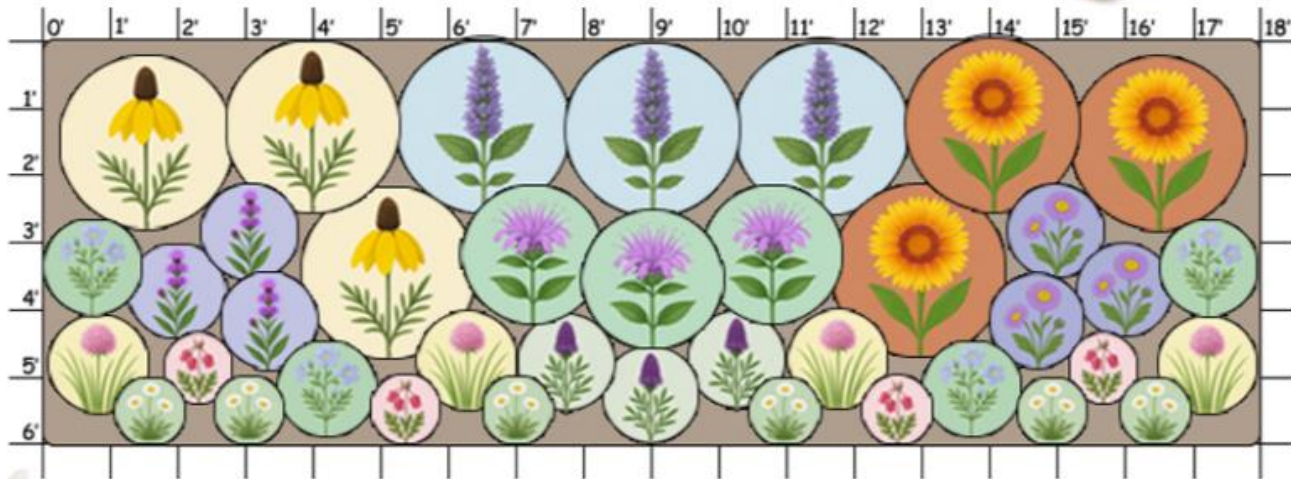

Brown-Eyed Susan
18-36" Tall - 3 Plants
Plant Code: BES



Wild Bergamot
18-36" Tall - 3 Plants
Plant Code: WB



Meadow Blazing Star
18-24" Tall - 3 Plants
Plant Code: MBS



Giant Hyssop
30-42" Tall - 3 Plants
Plant Code: GH



Wild Chives
12-24" Tall - 4 Plants
Plant Code: WC



Showy Jacobs Ladder
8-18" Tall - 4 Plants
Plant Code: SJL



Three Flowered Avenas
8-16" Tall - 4 Plants
Plant Code: 3FA



Yellow Coneflower
12-24" Tall - 3 Plants
Plant Code: YC



Purple Prairie Clover
12-24" Tall - 3 Plants
Plant Code: PPC



Streamside Fleabane
10-20" Tall - 3 Plants
Plant Code: SF



Cut-Leaved Fleabane
3-6" Tall - 6 Plants
Plant Code: CLF

This garden is planned to bloom from spring through fall, providing a steady food source for many pollinators. Native bees, butterflies, beetles, and other beneficial insects visit the flowers to collect nectar and pollen.



For more information about these native wildflowers and more visit www.wildaboutflowers.ca





Wild About Flowers

Native Plant Nursery



Let's design a Pollinator Garden.

Can you put the wildflowers in the right place? The circle sizes indicates the mature width of the plants. Use the heights listed below as clues to where the plants belong in this garden.

Polinator Garden

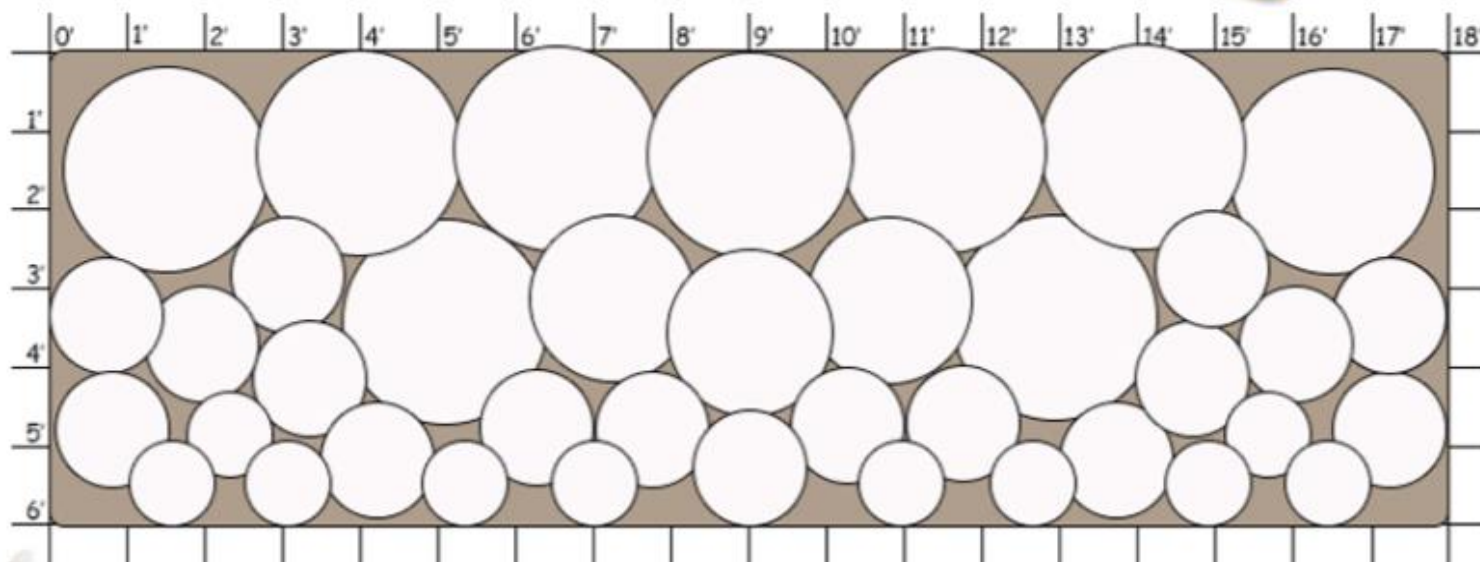

Brown-Eyed Susan
18-36" Tall - 3 Plants
Plant Code: BES



Giant Hyssop
30-42" Tall - 3 Plants
Plant Code: GH



Yellow Coneflower
12-24" Tall - 3 Plants
Plant Code: YC



Wild Bergamot
18-36" Tall - 3 Plants
Plant Code: WB



Wild Chives
12-24" Tall - 4 Plants
Plant Code: WC



Purple Prairie Clover
12-24" Tall - 3 Plants
Plant Code: PPC



Showy Jacobs Ladder
8-18" Tall - 4 Plants
Plant Code: SJL



Streamside Fleabane
10-20" Tall - 3 Plants
Plant Code: SF



Meadow Blazing Star
18-24" Tall - 3 Plants
Plant Code: MBS



Three Flowered Aven
8-16" Tall - 4 Plants
Plant Code: 3FA



Cut-Leaved Fleabane
3-6" Tall - 6 Plants
Plant Code: CLF

This garden is planned to bloom from spring through fall, providing a steady food source for many pollinators. Native bees, butterflies, beetles, and other beneficial insects visit the flowers to collect nectar and pollen.



For more information about these native wildflowers and more visit www.wildaboutflowers.ca



Garden layout examples and printable templates

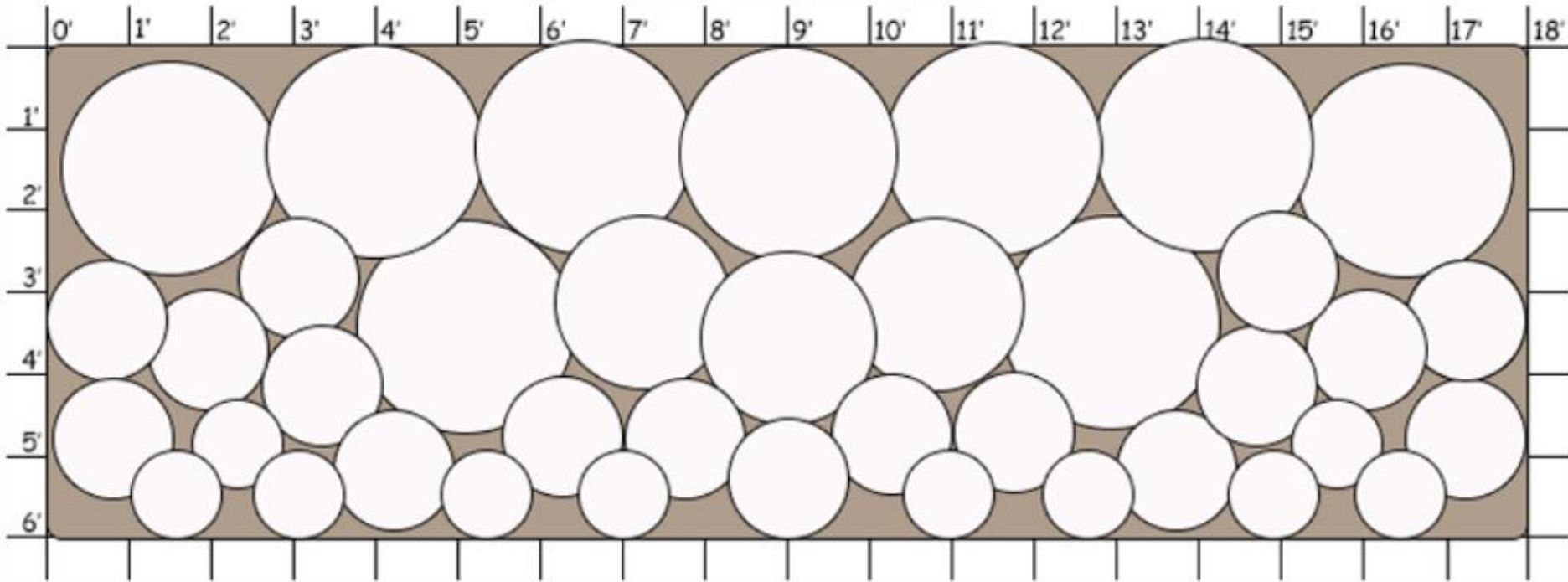

Wild About Flowers
Native Plant Nursery

Garden layout examples and printable templates



Wild About Flowers
Native Plant Nursery

Option 1) Drifts of Colour is ideal if you want bigger clusters of colour with a more formal appearance.

Option 2) A Mandala provides a more natural look with a more balanced mix of plants no matter which side you view it from.

Plant Index



Drifts of Colour

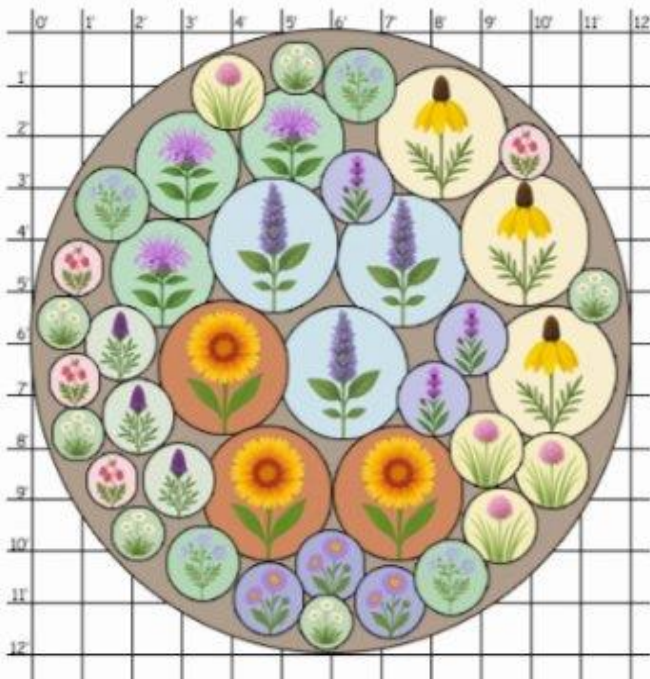

Mandala

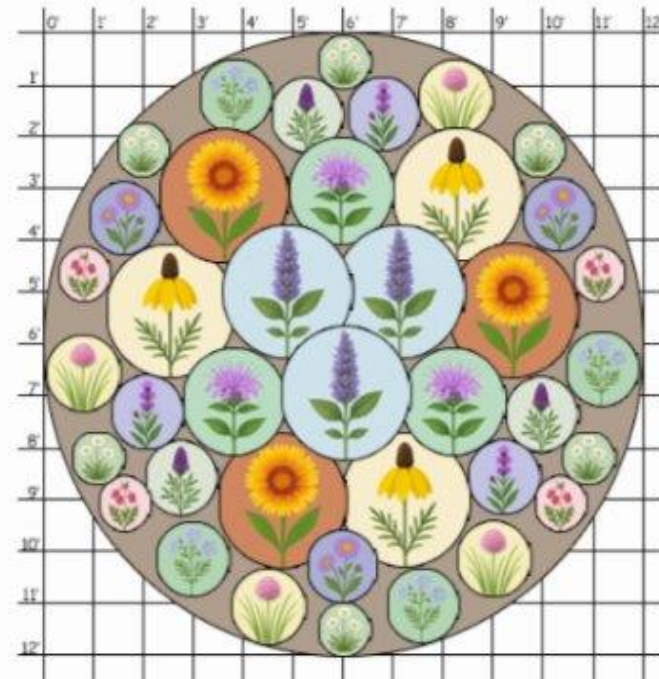

Garden layout examples and printable templates

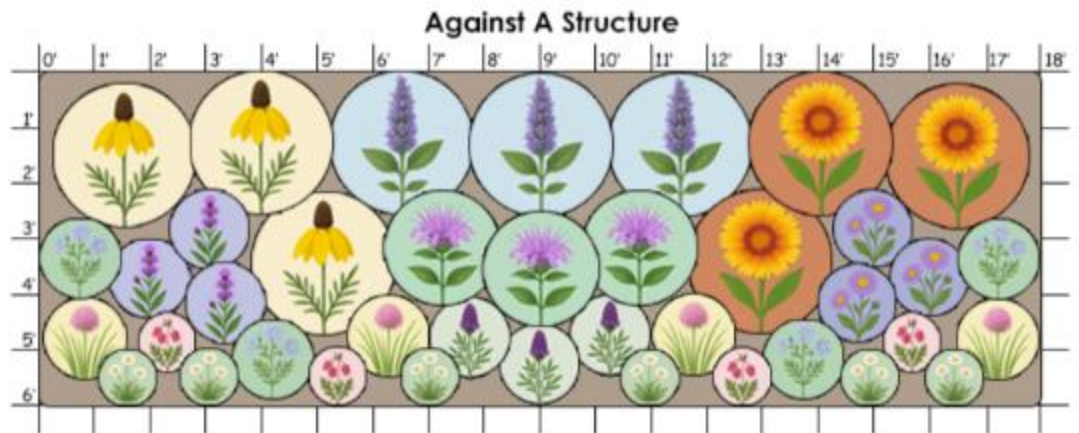
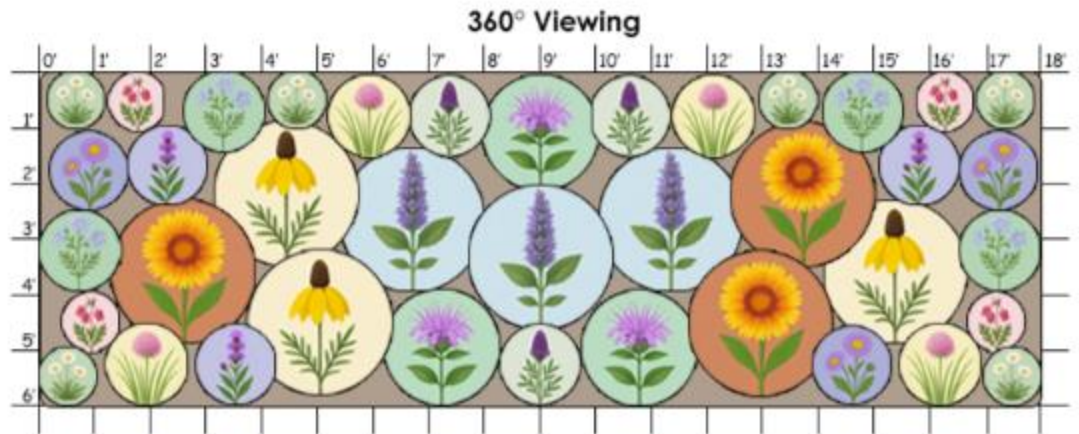
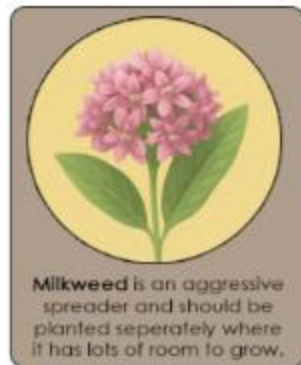
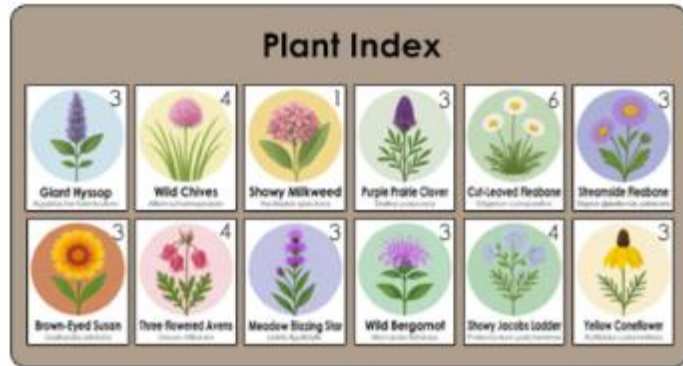

Wild About Flowers
Native Plant Nursery



Designs created by
Prairie Originals Nursery
in Winnipeg, **MB**

204-785-9799 kelly@prairieoriginals.com

www.prairieoriginals.com

[@prairieoriginals](https://www.instagram.com/prairieoriginals)

Location: 82051 Rd 30 E, St. Clements, MB

Mailing Address: Box 7, Grp 10, RR 1, East Selkirk, MB, R0E 0M0

Garden layout examples and printable templates

Wall

N	N	GA	WC	WC	WC	WC	GA	ST	ST
N	GA	SM	GH	GH	WB	WB	GA	SA	SA
H	SM	SM	GH	G	G	WB	M	M	SA
H	H	SH	SH	G	G	M	P	P	P

40 Plants Approximately 12" Spacing

2	ST	Stiff Goldenrod
3	GH	Giant Hyssop
4	G	Gaillardia
2	SH	Showy Goldenrod
4	GA	Golden Alexander
3	SA	Smooth Aster
3	WB	Wild Bergamot
3	H	Harebell
3	M	Meadow Blazing Star
3	SM	Swamp Milkweed
4	WC	Wild Columbine
3	P	Purple Prairie Clover
3	N	New England Aster

**Prairie
Originals**

WILDFLOWERS
NATIVE GRASSES



Garden layout examples and printable templates

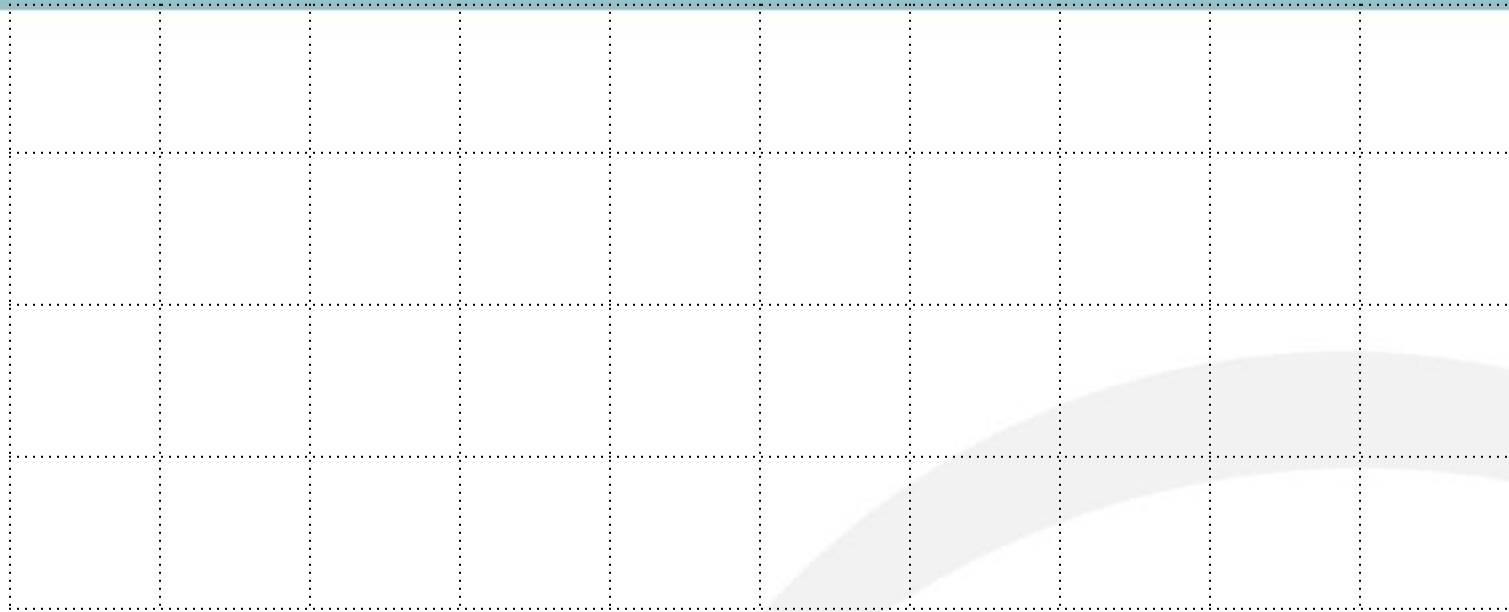

40 Plants Approximately 12" Spacing

3 WB Wild Bergamot
3 H Harebell
3 M Meadow Blazing Star
3 SM Swamp Milkweed
4 WC Wild Columbine
3 P Purple Prairie Clover
3 N New England Aster

2 ST Stiff Goldenrod
3 GH Giant Hyssop
4 G Gaillardia
2 SH Showy Goldenrod
4 GA Golden Alexander
3 SA Smooth Aster

**Prairie
Originals**

WILDFLOWERS
NATIVE GRASSES



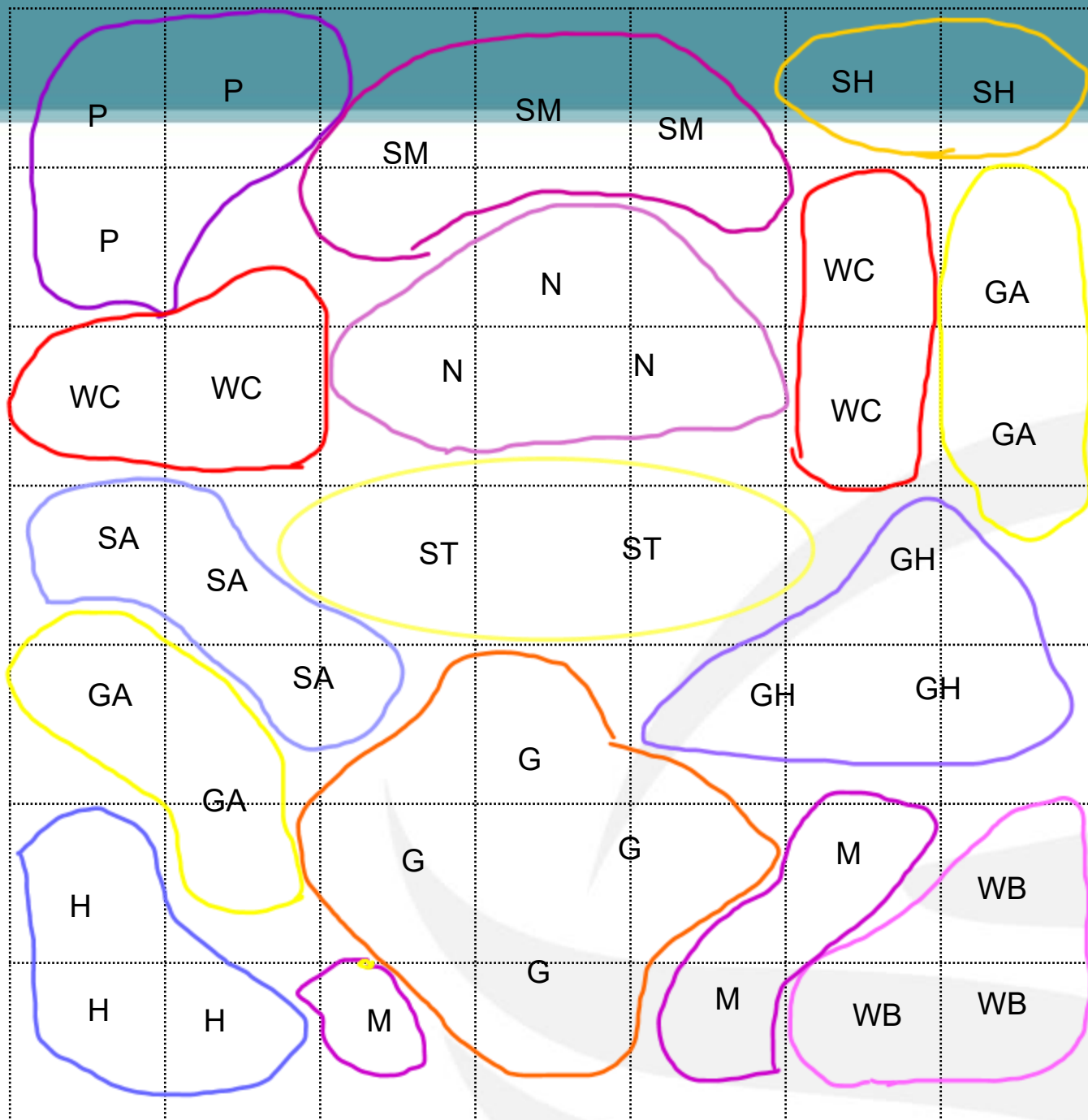

**Prairie
Originals**

WILDFLOWERS
NATIVE GRASSES



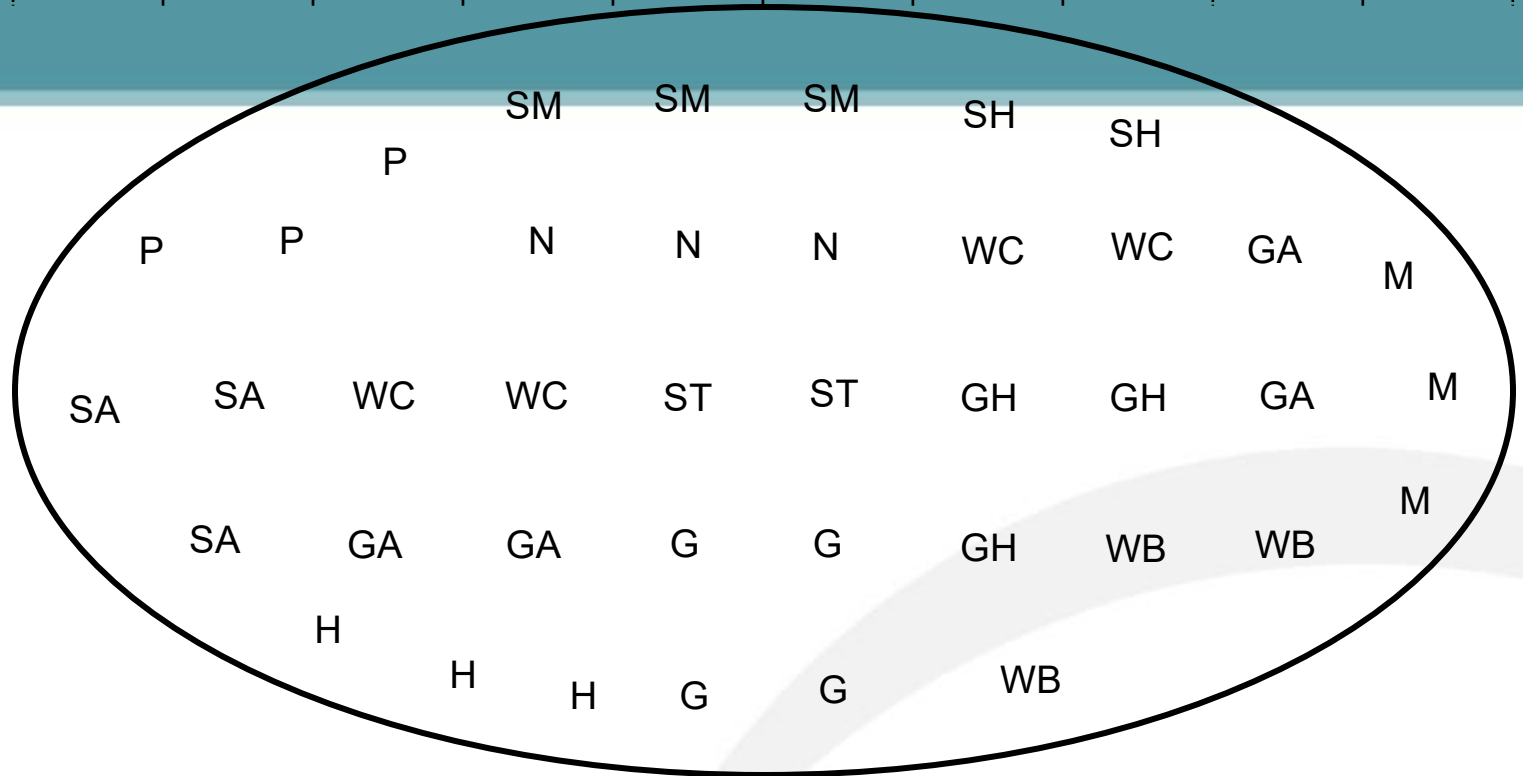

40 Plants Approximately 12" Spacing

3 WB Wild Bergamot

3 H Harebell

3 M Meadow Blazing Star

3 SM Swamp Milkweed

4 WC Wild Columbine

3 P Purple Prairie Clover

3 N New England Aster

2

3

4

2

4

3

ST

GH

G

SH

GA

SA

Stiff Goldenrod

Giant Hyssop

Gaillardia

Showy Goldenrod

Golden Alexander

Smooth Aster

**Prairie
Originals**

WILDFLOWERS
NATIVE GRASSES



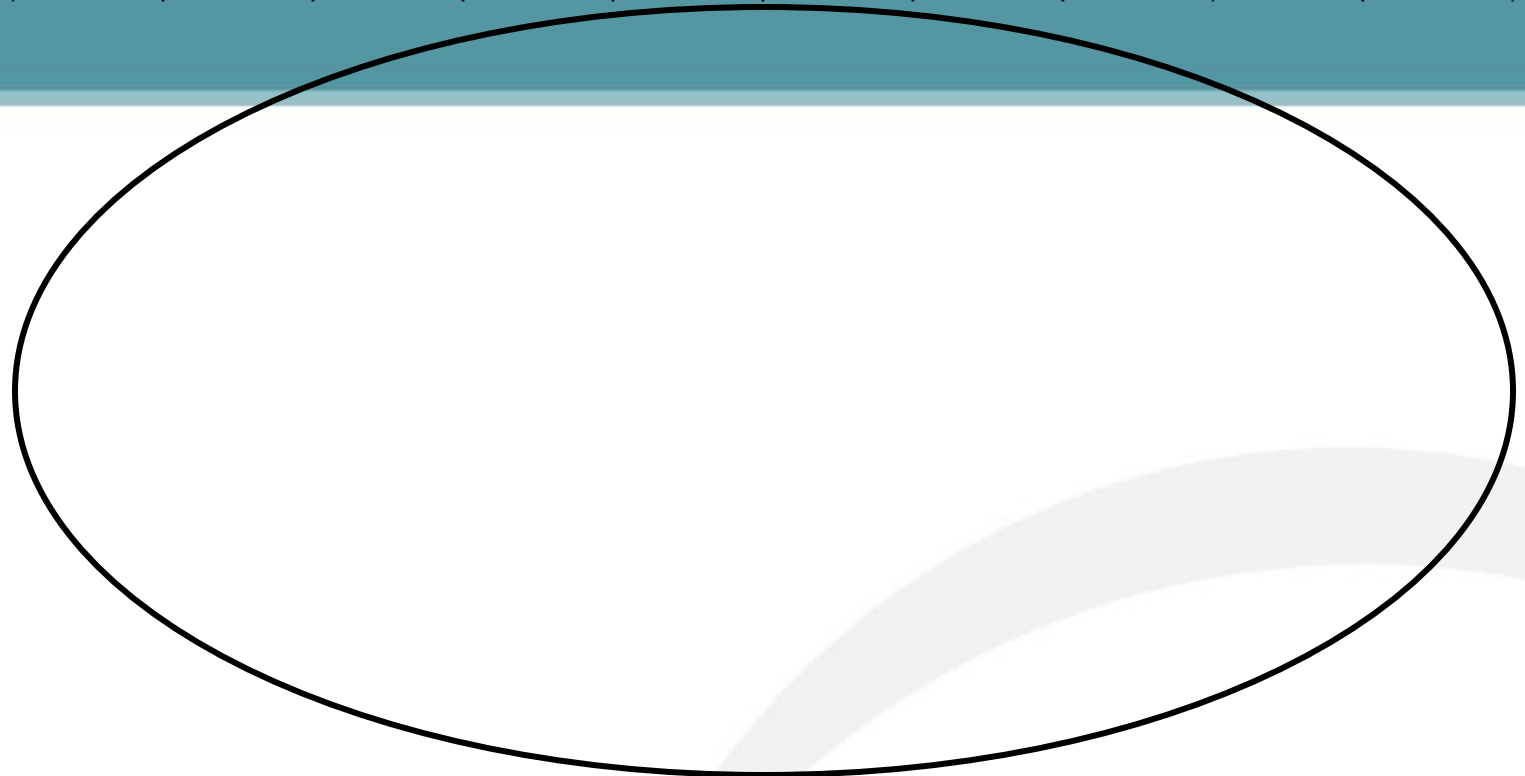

40 Plants Approximately 12" Spacing

3 WB Wild Bergamot

3 H Harebell

3 M Meadow Blazing Star

3 SM Swamp Milkweed

4 WC Wild Columbine

3 P Purple Prairie Clover

3 N New England Aster

2

3

4

2

4

3

ST

GH

G

SH

GA

SA

Stiff Goldenrod

Giant Hyssop

Gaillardia

Showy Goldenrod

Golden Alexander

Smooth Aster



Garden layout examples and printable templates

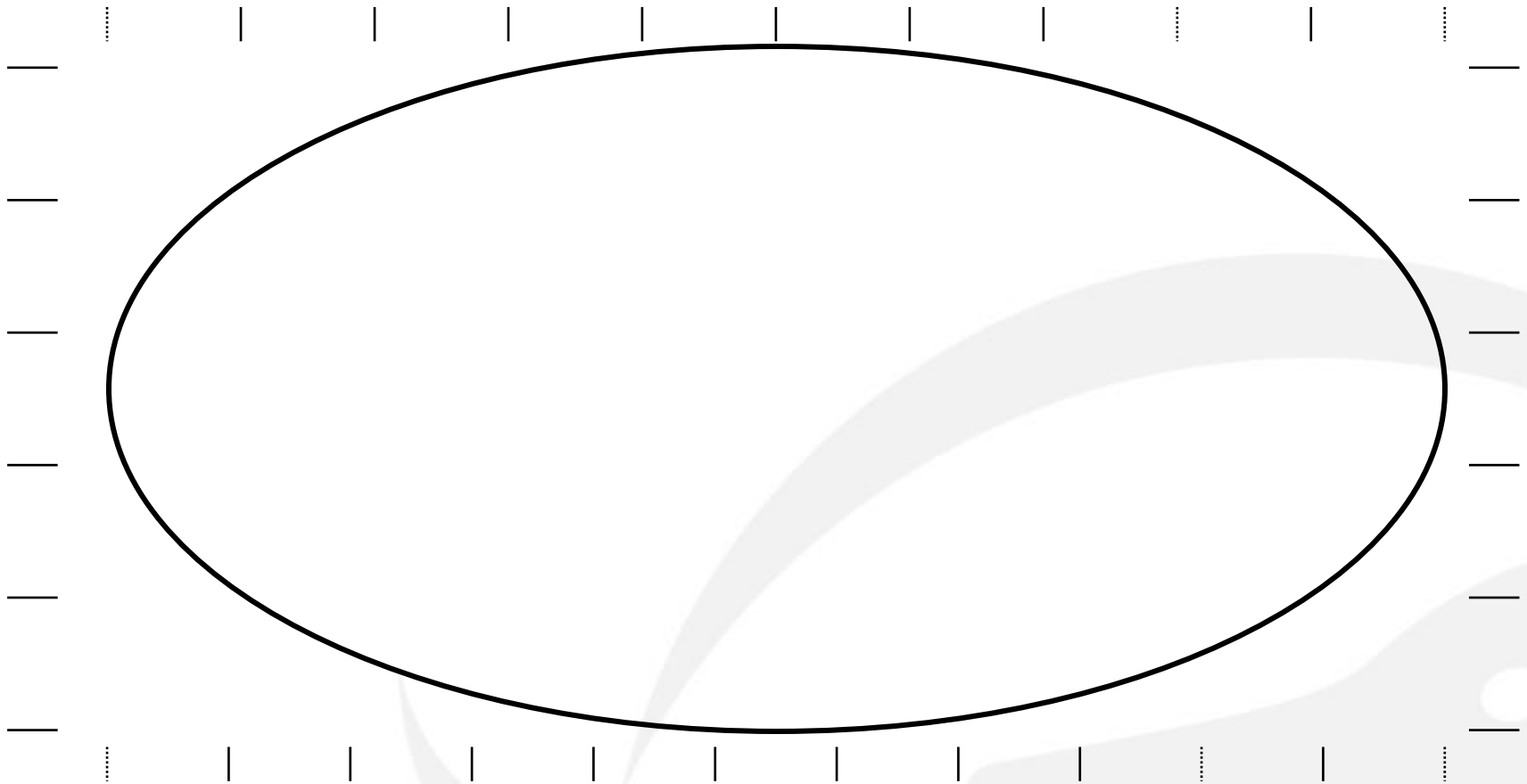

Approximately 12" Spacing



Designs created by
Echo Native Plants
in Ottawa, ON

echonativeplants@gmail.com

<https://www.echonativeplants.ca/>

Location: 1883 Old Perth Rd, Almonte, ON K0A 1A0



Rectangular Garden Beds

Option 1: Back to Front

Ideal to use when garden is being viewed from mainly the front and is against a fence or building

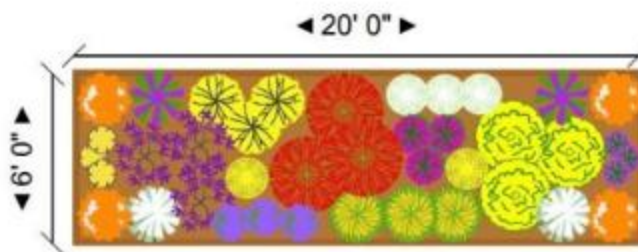
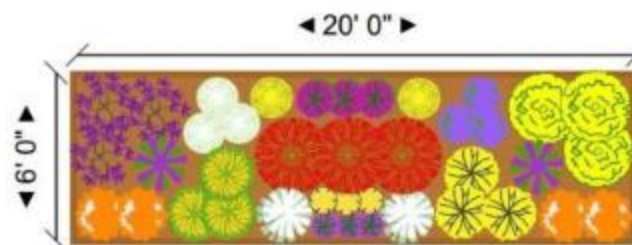

Option 2: All Around

Ideal to use when garden can be viewed from all angles such as in an open space with grass all around.

Plant Index

- | | | | |
|--------------------|------------------------|--------------------|------------------------|
| Ohio Spiderwort | Prairie Sundrops | Hoary Vervain | Virginia Mountain Mint |
| Butterfly Milkweed | Pearly Everlasting | Showy Goldenrod | Scarlet Beebalm |
| New England Aster | Black Eyed Susan | Great Blue Lobelia | Lance-Leaf Coreopsis |
| Dense Blazing Star | Grey Headed Coneflower | | |



Round Garden Beds

Option 1: 'Drifts'

Ideal if you want bigger clusters of colour with a tidier more formal look.

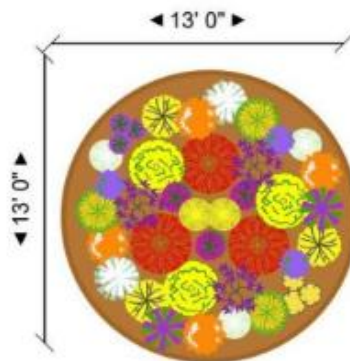
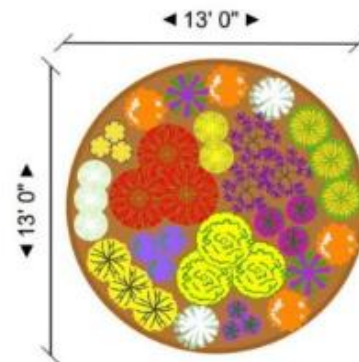

Option 2: 'Mandala'

Ideal for a more natural garden look while having a repeating pattern giving smaller pops of colour throughout the garden.

Plant Index

- | | |
|------------------------|--------------------|
| Ohio Spiderwort | Prairie Sundrops |
| Butterfly Milkweed | Pearly Everlasting |
| New England Aster | Black Eyed Susan |
| Virginia Mountain Mint | Dense Blazing Star |
| Scarlet Beebalm | Hoary Vervain |
| Lance-Leaf Coreopsis | Showy Goldenrod |
| Grey Headed Coneflower | Great Blue Lobelia |